

# Replace Indicator Lamp

## INSTRUCTION MANUAL

**TOOL(S) NEEDED:**

- Wrench
- Pliers

1. Shut off power to cabinet by turning off circuit breaker. Unplug power cord from wall outlet.
2. Open front service panel or remove top where pertinent on cabinet.
3. Slip small insulators from wire terminals and disconnect electrical wires from indicator lamp.
4. Slide or push indicator lamp through hole from back of panel (as shown in **Figure 1**).
5. Push replacement indicator lamp through hole form front of panel. Use pliers to aid as shown in **Figure 2** if necessary.
6. Place electrical wires on replacement indicator lamp and replace insulator sleeves (**Figure 3**).
7. Close front panel or replace top where pertinent on cabinet.
8. Reconnect power cord to wall outlet and turn circuit breaker on.

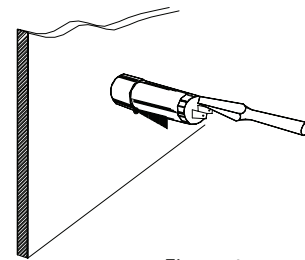

Figure 1

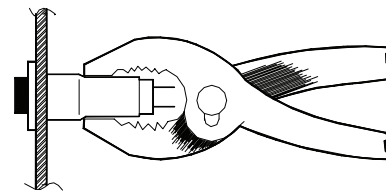

Figure 2

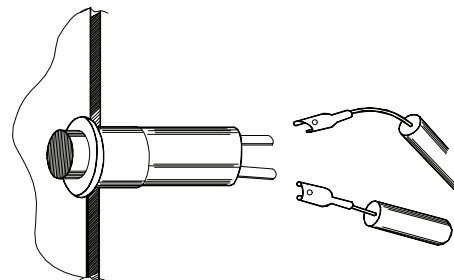

Figure 3

**Buy Winston service parts online!**  
Factory direct at [www.winstonparts.com](http://www.winstonparts.com)